



jt | JORGENSENTURNER



Chamberlayne Road,
London, London

£1,350 Per Month



1



1



1



E



Chamberlayne Road, London, London

£1,350 Per Month



Summary Description

Charming studio flat available from 18th of February. Boasting spacious open plan studio reception/sleeping area, open plan fitted kitchen area, fully fitted shower room. Property has high ceiling for airy feeling, double glazed, good storage.

Located on the popular Chamberlayne road minutes walk from both Kensal Rise Station and Queens Park, popular restaurants, bars, coffee shops and boutique shops. Perfect for a working professional single or couple.

Extra £250 is paying to the landlord for the utility bills overall rent with bills making £1600pcm, contribution towards wifi is extra £15p/m

Call Jorgensen Turner Estate Agents to book a viewing or get more information. One weeks holding deposit required, 5 weeks damage deposit will be required.

Area Map

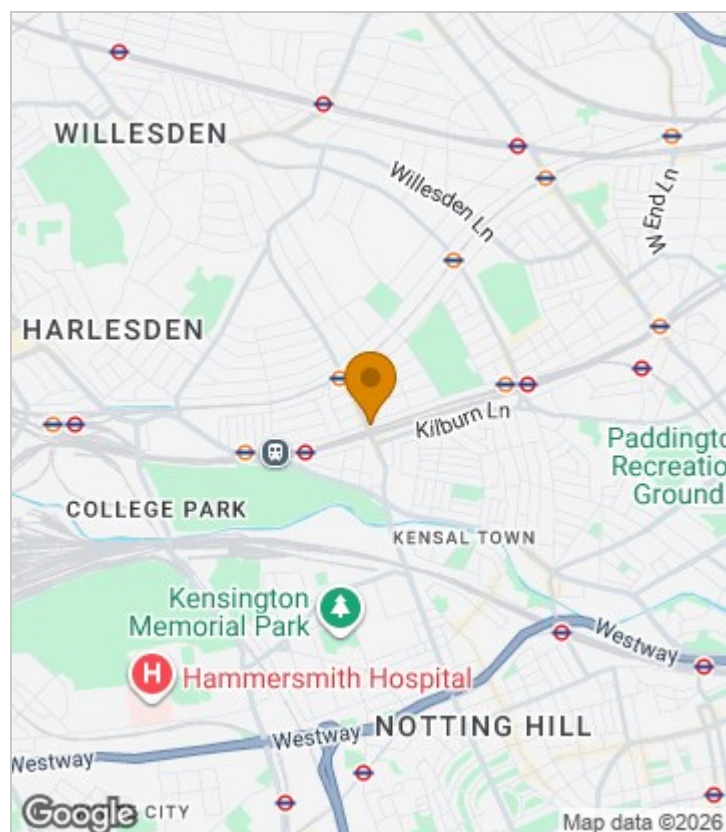



Floor Plan

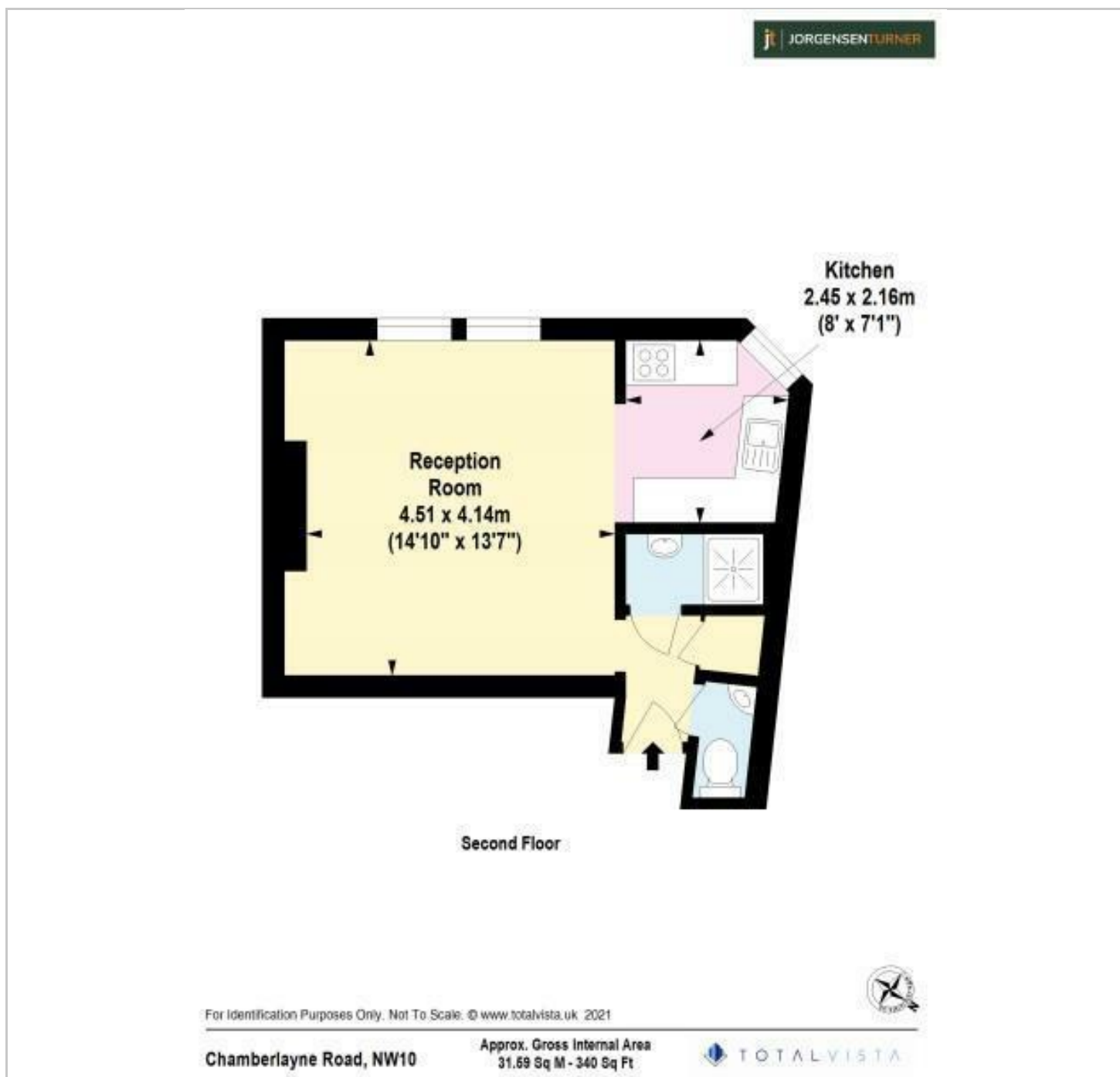

Energy Efficiency Graph

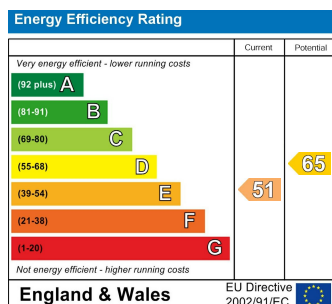

Viewing

Please contact our Lettings QP Office on 0207 604 4040 if you wish to arrange a viewing appointment for this property or require further information.

- Large studio flat
- Private kitchen
- Private bathroom
- Double glazed windows
- £245 contribution for utility bills
- £15 contribution for WIFI
- Furnished

For further information contact:

Lettings QP, 2a Brondesbury Road, London, NW6 6AS

Tel: 0207 604 4040 Email: info@jorgensenturner.com <https://www.jorgensenturner.com/>

Disclaimer

These particulars, whilst believed to be accurate are set out as a general outline only for guidance and do not constitute any part of an offer or contract. Intending purchasers should not rely on them as statements of representation of fact, but must satisfy themselves by inspection or otherwise as to their accuracy. No person in this firm's employment has the authority to make or give any representation or warranty in respect of the property.

